

● 夹爪锁紧电缆插头TK Plug for plastic clamping-nut TK

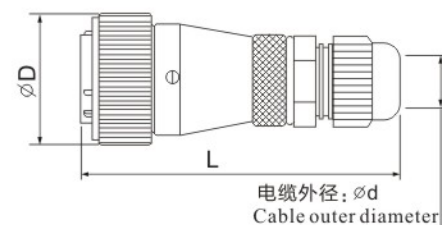

尺寸 Dimension(mm)	HS16	HS20	HS24	HS28	HS32	HS40	HS48	HS55
ØD	22	26	30	34	39	49	57	65
L	68	76	86	90	106	110	130	134
Ød	PG9 4-8	PG11 5-10	PG11 5-10	PG16 10-14	PG21 13-18	PG25 16-21	PG25 16-21	PG29 18-25

● 直式双压板电缆插头TY Plug with cable clamping plates TY

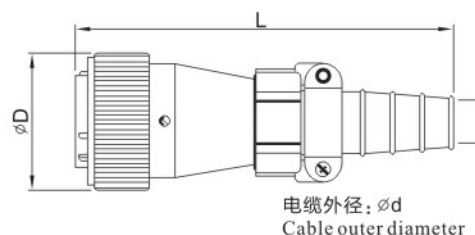

尺寸 Dimension(mm)	HS16	HS20	HS24	HS28	HS32	HS40	HS48	HS55
ØD	22	26	30	34.5	39.5	49.5	57	64.5
L	72.5	87	92	100.5	118.5	130.5	140	163
Ød	7-8	8-10.5	8-10.5	11.5-13.6	13-15.6	15.5-18.8	I:15.5-18.8 II:24-28	24-28

● 弯式双压板电缆插头:TS Plug with angled back shell with cable clamping plates: TS

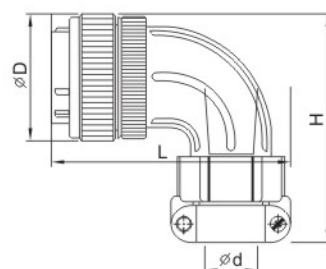

尺寸 Dimension(mm)		HS20	HS24	HS28	HS32	HS40	HS48	HS55
ØD	—	27.5	31	35	39	49.5	57	65
H	—	53.5	56	61	67.5	78	91	99.5
L	—	60	60	64	81	88	95	106
Ød max	—	13.5	13.5	16.8	19	23.5	24	32



CE认证

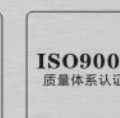

ISO认证

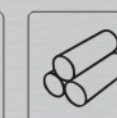

金属外壳



防火阻燃

● HF系列 HF Series

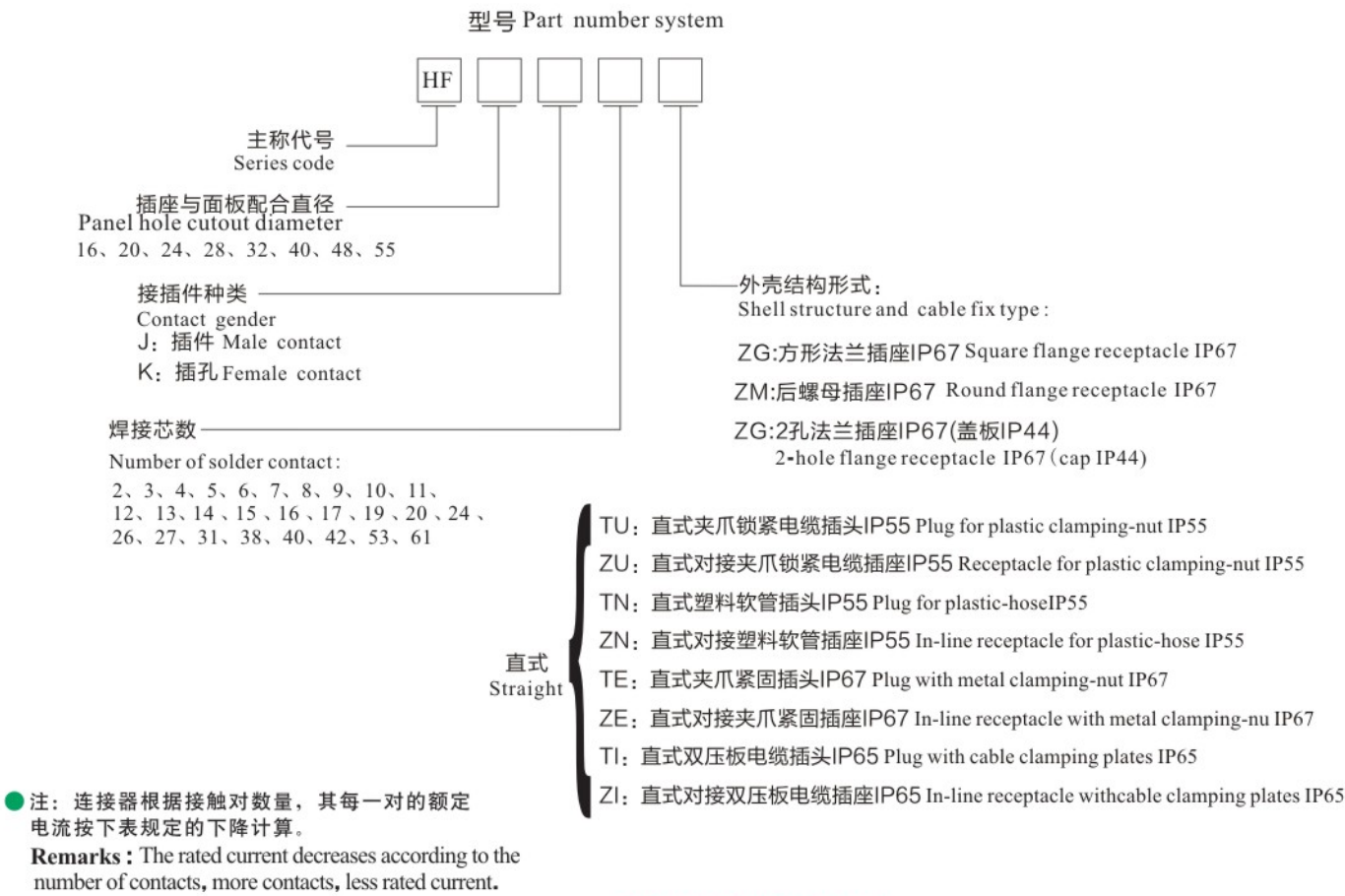

接触对芯数 Number of contact	1~3	4~10	11~20	21~30	31~40	41~50	51~61
下降率 (%) Rated current decrease rate	0	10	20	30	40	50	60

★ 接触件可以是插针或插孔
Each side can be male or female contact

材料和技术参数 Material and spec

接插方式	Coupling	螺纹连接	Threaded
外壳材料	Shell material	锌合金(镀铬)	Zinc alloy with chrome plating
绝缘体	Insert material	热塑塑料PPS, 耐高温260	PPS, max temperature 260 ℃
接触件材料	Contact material	铜(镀金)	Brass with gold plating
接线方式	Termination	焊接: Φ1、Φ1.5、Φ2.5、Φ3.5、Φ5.5mm。 Solder: Φ1、Φ1.5、Φ2.5、Φ3.5、Φ5.5mm。	
接插次数	Mating cycle	500	
温度范围	Temperature range	-40℃ ~+85℃	

HF系列配套表 HF Series Mating diagram

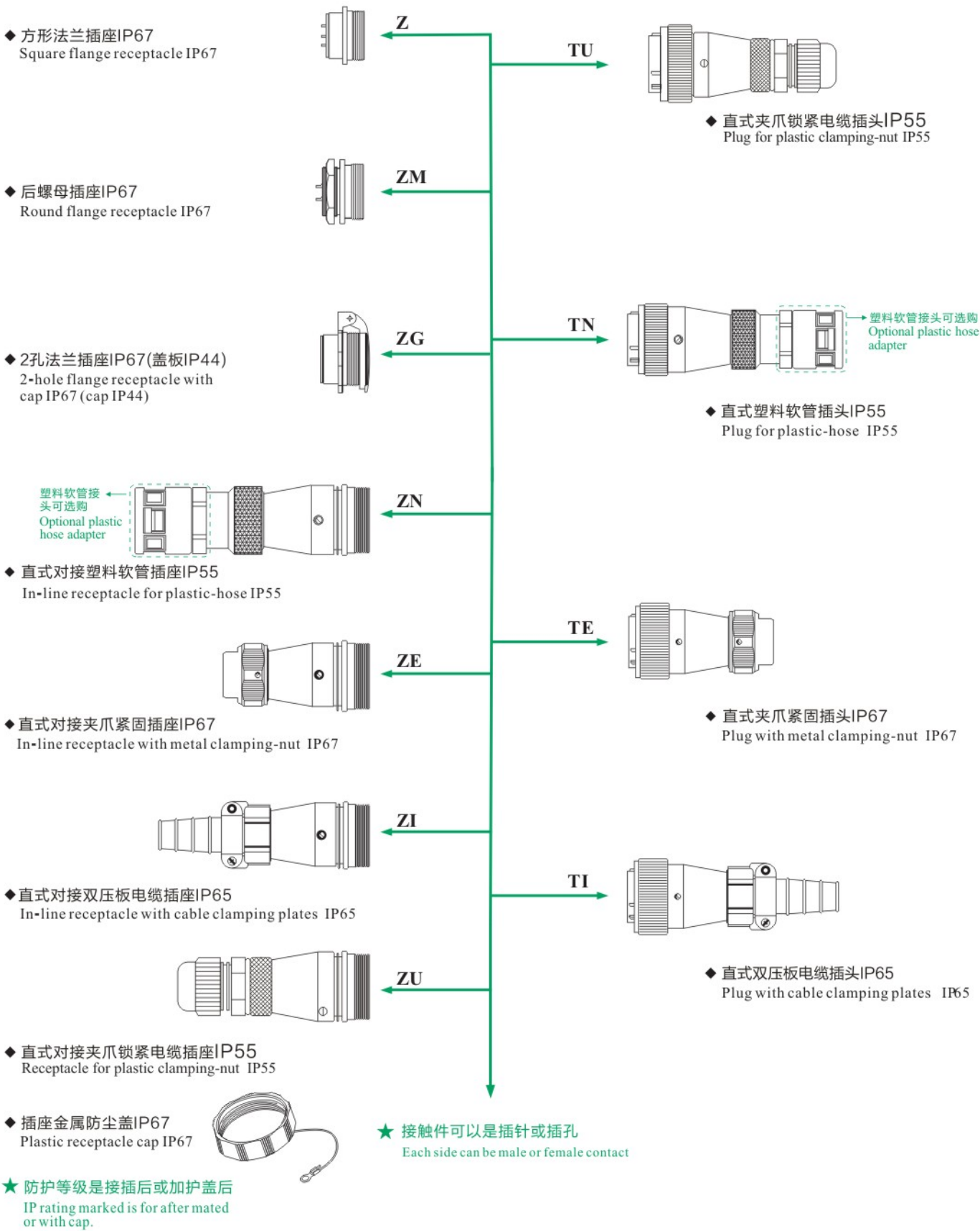

● 方形法兰插座 Z IP67 Square flange receptacle: Z IP67

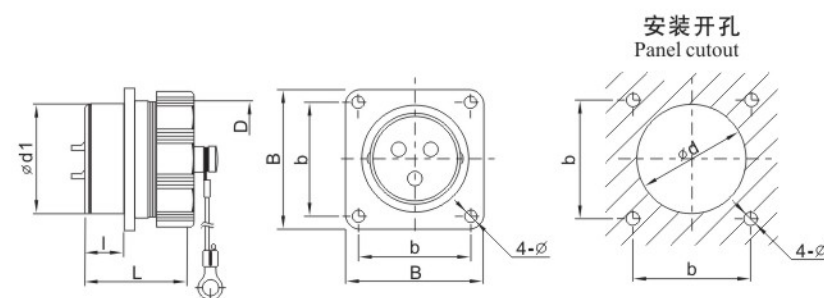

尺寸 Dimension(mm)	HF16	HF20	HF24	HF28	HF32	HF40	HF48	HF55
∅d1	15.8	19.8	23.8	27.8	31.8	39.8	47.8	54.8
D	M18X1	M22X1	M26X1	M30X1	M35X1	M44X1	M52X1.5	M59X1.5
I	9.7	9.8	10	9.8	14.4	14.2	14.2	14
L	21.6	23	23	23	34	34	34	34
b	20	22	26	30	32	40	48	52
B	26	29	32	36	42	50	58	64
∅d	16.5	20.5	24.5	28.5	32.5	40.5	48.5	55.5
∅	3.2	3.2	3.2	3.2	3.5	4.5	4.5	4.5

● 后螺母插座 ZM IP67 Round flange receptacle: ZM IP67

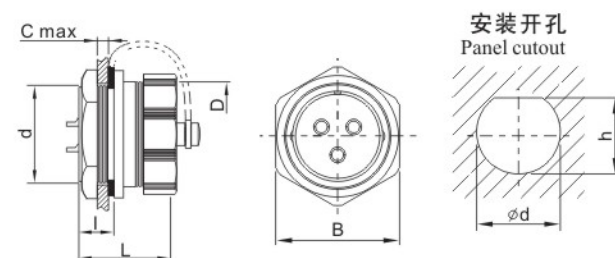

尺寸 Dimension(mm)	HF16	HF20	HF24	HF28
d	M16X1	M20X1	M24X1	M28X1
D	M18X1	M22X1	M26X1	M30X1
C	5	5	5	5
I	9.7	9.9	10	10.2
L	22	23	23	23
B	21.2	25.5	29.2	33.3
∅d	15.7	19.7	23.9	27.7
h	15.3	19.3	23.2	26.9

● 2孔法兰插座 ZG IP67(盖板IP44) 2-hole flange receptacle with cap: ZG IP67(cap IP44)

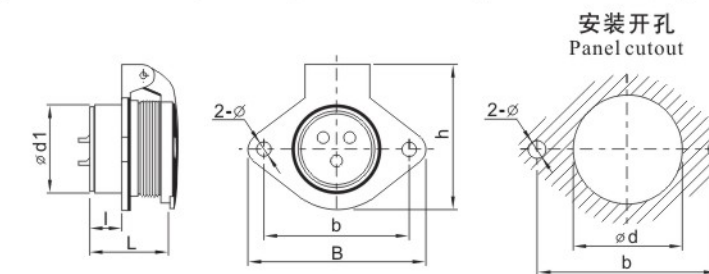

尺寸 Dimension(mm)	HF16	HF20	HF24	HF28	HF32	HF40	HF48	HF55
∅d1	15.8	19.8	23.8	27.8	31.8	39.8	47.8	54.8
I	10	10	10	10	15.4	14.7	14.3	14
L	22	23	23	23	34	34	34	34
b	30	35	40	45	55	65	80	85
B	38	44	50	55	67	77	92	98
h	32.5	36.5	40.5	45.5	52.5	63.5	74.5	80
∅d	16.5	20.5	24.5	28.5	32.5	40.5	48.5	55.5
∅	3.5	4.5	4.5	4.5	5.5	5.5	5.5	6.5

● 直式对接夹爪紧固插座 ZE: IP67 In-line receptacle with metal clamping-nut B: ZE IP67

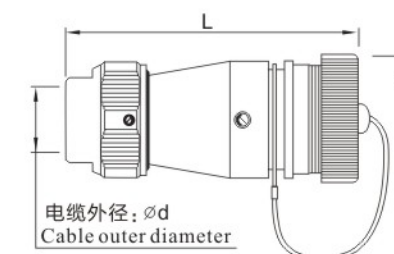

尺寸 Dimension(mm)	HF16	HF20	HF24	HF28	HF32	HF40	HF48	HF55
D	M18X1	M22X1	M26X1	M30X1	M35X1.5	M44X1.5	M52X1.5	M59X1.5
L	55	63	66.5	70	90.5	99.5	108	134.5
∅d	5-6.5	9-10.5	9-10.5	10.5-12.5	15.5-17	18-20	I:18-20(不标) II: 24.5-26	24.5-26

● 直式对接双压板电缆插座: ZI IP65 In-line receptacle with cable clamping plates : ZI IP65

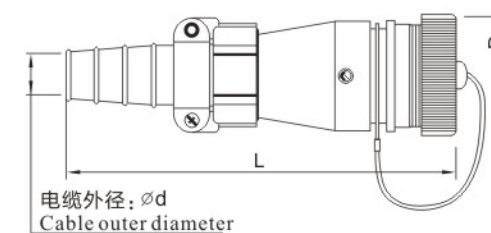

尺寸 Dimension(mm)	HF16	HF20	HF24	HF28	HF32	HF40	HF48	HF55
D	M18X1	M22X1	M26X1	M30X1	M35X1.5	M44X1.5	M52X1.5	M59X1.5
L	73.5	90	93.5	104	118.5	130	137	163
∅d	7-8	8-10.5	8-10.5	11.5-13.6	13-15.6	15.5-18.8	I:15.5-18.8(不标) II: 24-28	24-28

● 直式对接塑料软管插座ZN:IP55 In-line receptacle for plastic-hose: ZN IP55

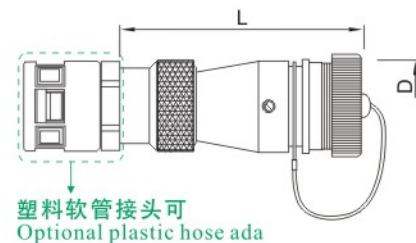

尺寸 Dimension(mm)	HF16	HF20	HF24	HF28	HF32	HF40	HF48	HF55
D	M18X1	M22X1	M26X1	M30X1	M35X1.5	M44X1.5	M52X1.5	M59X1.5
L	54.5	64	67	73	86.5	95	104	120
接头规格 Adapter size	PG7	PG11	PG11	PG16	PG21	PG29	I: PG29 (不标) II: PG36	PG36
管规 Hose size	1/4"	3/8"	3/8"	1/2"	3/4"	1"	I: 1" (不标) II: 1 1/4"	1 1/4"

● 直式对接夹爪锁紧电缆插座ZU:IP55 Receptacle for plastic clamping-nut ZU:IP55

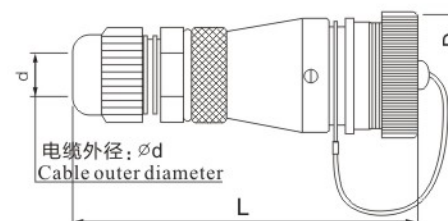

尺寸 Dimension(mm)	HF16	HF20	HF24	HF28	HF32	HF40	HF48	HF55
ØD	M18×1	M22×1	M26×1	M30×1	M35×1.5	M44×1.5	M52×1.5	M59×1.5
L	68	76	86	90	106	110	130	134
Ød	PG9 4-8	PG11 5-10	PG11 5-10	PG16 10-14	PG21 13-18	PG25 16-21	PG25 16-21	PG29 18-25

● 直式双压板电缆插头TI:IP65 Plug with cable clamping plates: TI IP65

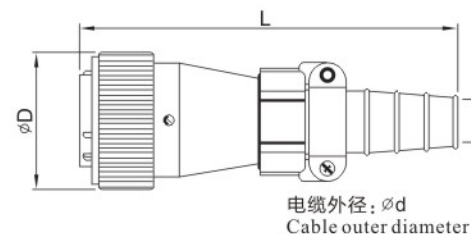

尺寸 Dimension(mm)	HF16	HF20	HF24	HF28	HF32	HF40	HF48	HF55
ØD	22	26	30	34.5	39.5	49.5	57	64.5
L	72.5	87	92	100.5	118.5	130.5	140	163
Ød	7-8	8-10.5	8-10.5	11.5-13.6	13-15.6	15.5-18.8	I: 15.5-18.8 II: 24-28	24-28

● 直式夹爪紧固插头TE: IP67 Plug with metal clamping-nut: TE IP67

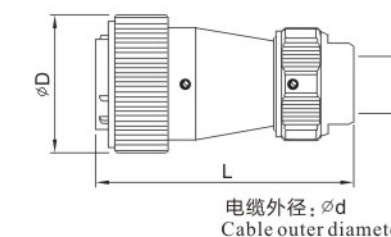

尺寸 Dimension(mm)	HF16	HF20	HF24	HF28	HF32	HF40	HF48	HF55
ØD	22	26	30	34.5	39.5	49.5	57	64.5
L	54.5	62.5	65	68	88	100	110	131.5
Ød	5-6.5	9-10.5	9-10.5	10.5-12.5	15.5-17	18-20	I: 18-20 (不标) II: 24.5-26	24.5-26

● 直式夹爪锁紧电缆插头TU:IP55 Plug for plastic clamping-nut TU:IP55

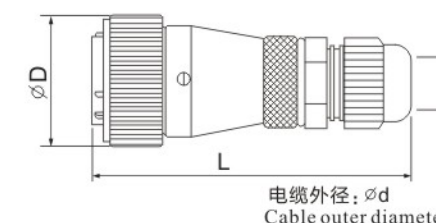

尺寸 Dimension(mm)	HF16	HF20	HF24	HF28	HF32	HF40	HF48	HF55
ØD	22	26	30	34	39	49	57	65
L	68	76	86	90	106	110	130	134
Ød	PG9 4-8	PG11 5-10	PG11 5-10	PG16 10-14	PG21 13-18	PG25 16-21	PG25 16-21	PG29 18-25

● 直式塑料软管插头TN:IP55 Plug for plastic-hose TN: IP55

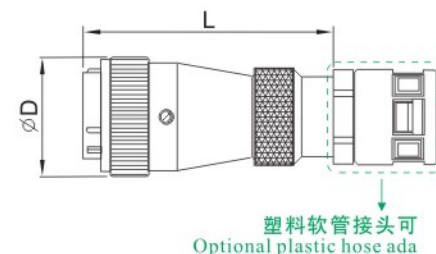

尺寸 Dimension(mm)	HF16	HF20	HF24	HF28	HF32	HF40	HF48	HF55
ØD	22	26	30	34.5	39.5	49.5	57	64.5
L	54	62.5	66.5	72.5	87.5	95	105	118
接头规格 Adapter size	PG7	PG11	PG11	PG16	PG21	PG29	I: PG29 (不标) II: PG36	PG36
管规 Hose size	1/4"	3/8"	3/8"	1/2"	3/4"	1"	I: 1" (不标) II: 1 1/4"	1 1/4"